

Mounting Pattern (Foot)

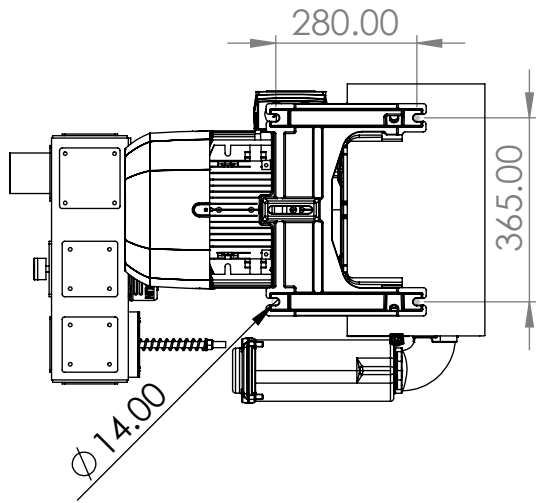

Mounting Pattern (Face)

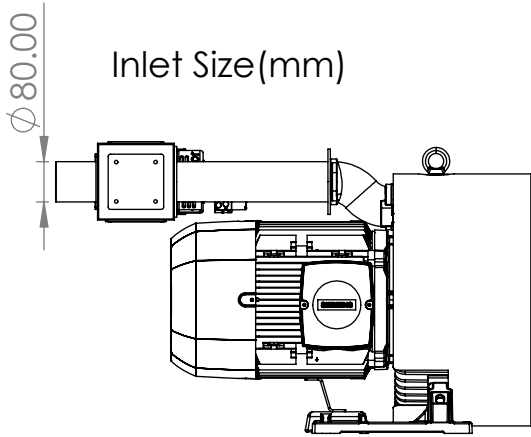
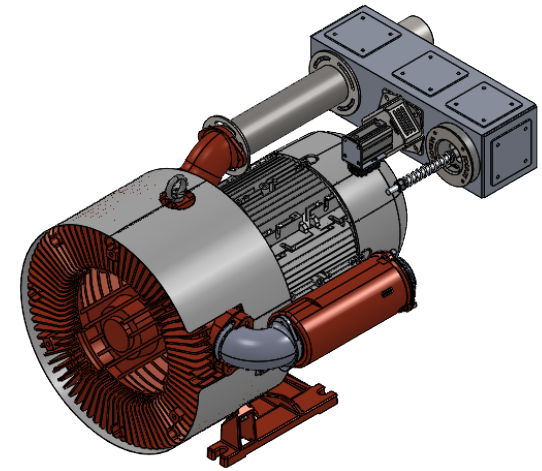
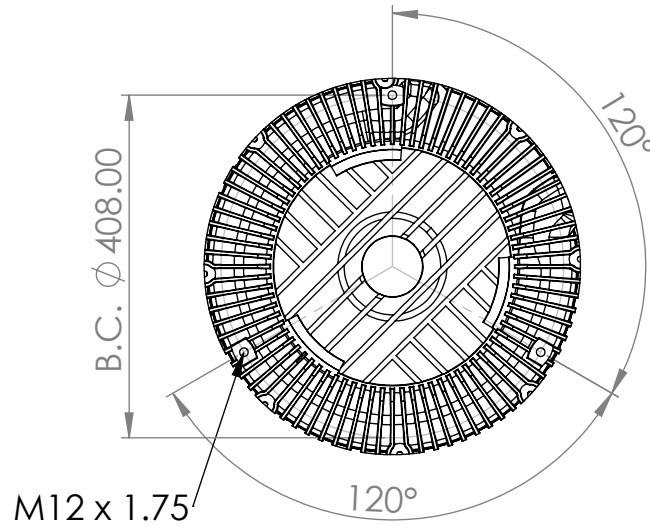

Inlet Size (mm)

DETAIL A

SCALE 1 : 9

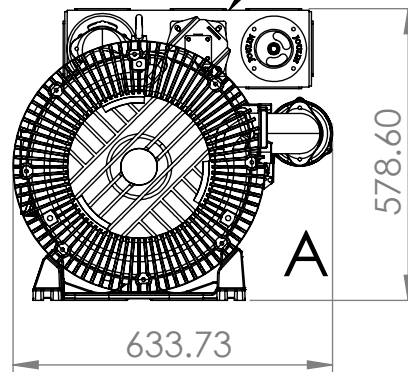

Blower Control Module

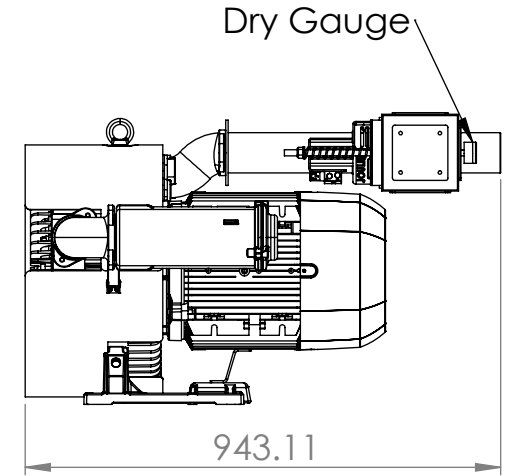

Dry Gauge

Frequency [Hz]	Phase	Rated Motor Power [kW]	Max Vacuum [mbar]	Input voltage [V]	Input Motor Current [A]	Flow at zero Vacuum [m3/h]	Sound pressure level Db [A]	Weight kg [Lb]	Weight kg [Lb] w/BCM
Reference : 2BH1810-0HK36 / PN : 0000.036.000.012 - Assembly Reference (Includes BCM) : 0000.036.001.005									
50	3	12.6	-460	YY 190-210	46.6	520	71	200 [441]	208.5 [459]
				Δ 220-240	40.3				
				Y 380-420	23.3				
60	3	14.5	-480	YY 220-240	46	625	76		
				Y 440-480	23				
85	3	20.5	-480	Δ 400	39.5				
Reference : 2BH1810-0HQ33 / PN : 000.036.000.016 - Assembly Reference (Includes BCM) : 0000.036.001.007									
50	3	12.6	-420	Δ 475-525	18.5	520	71	182[401]	190.5 [419.5]
60	3	14.5	-440	Δ 550-600	18.4	625	76		



Scale: 1:15

Rev:

